

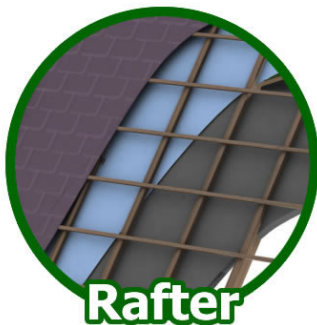

Product Quick Guide

This quick guide is designed to show the most common places to insulate within your home, along with suggested products and recommended material depth to exceed regulation guidelines.



Rafter

Existing/Renovation: Min 125mm
(Layer 50mm + 75mm Premium Rolls)

New Build: 200mm
Layer 2 x 100mm Premium Rolls

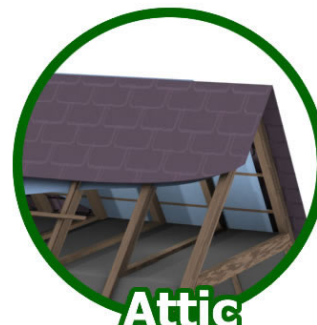

Attic

Existing/Renovation: Min 150mm

New Build: 250mm between and over joists
(Premium or Comfort rolls suitable)



Internal Wall

Fill Wall to Stud Depth
Usually 75mm/100mm Premium Rolls



Timber Floor

Structureborne Acoustic Insulation
Between Top Layer & Subfloor: SilentWool: Floor
Between Subfloor & Joist: SilentWool: Joist

Airborne Acoustic/Thermal Insulation
Insulation Roll b/n Joists: 100mm
(Premium or Comfort rolls suitable)

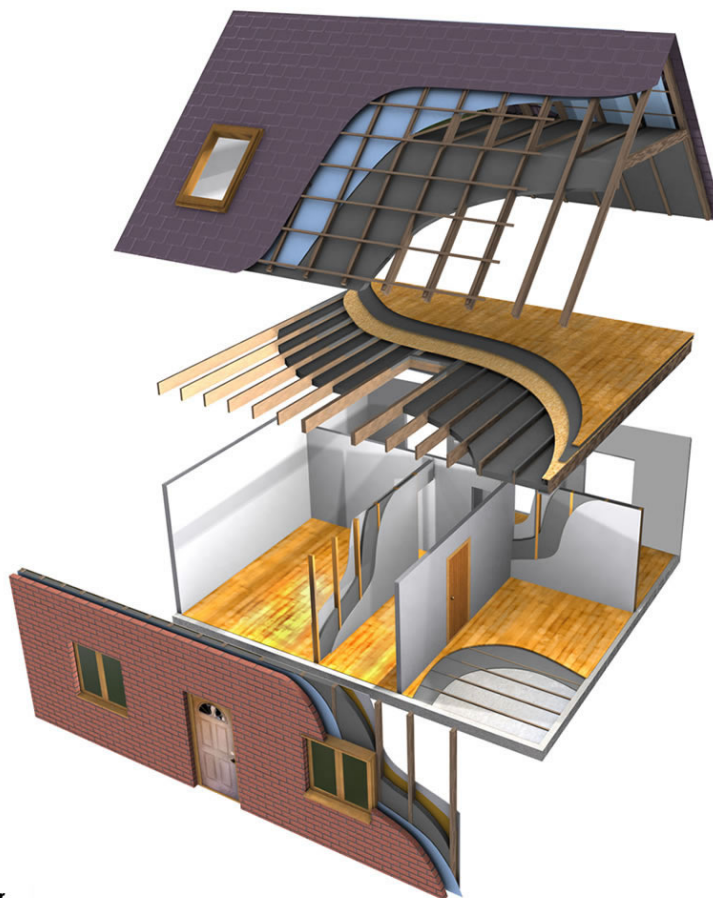

External Wall

Timber Frame: 150mm Premium rolls

Internal Dry Lining: Min 50mm Premium rolls
(Depending on Wall type)



Concrete Floor

Structureborne Acoustic Insulation
Between Top Layer & Subfloor: SilentWool: Joist
Between Joist & Concrete: SilentWool: Floor

Airborne Acoustic/Thermal Insulation
Insulation Roll b/n Joists: Min 75mm
(Premium or Comfort rolls suitable)

www.sheepwoolinsulation.ie